

# Inflatable Restraint Passenger Seat Suppression Module Replacement

## Removal Procedure

**Caution:** Refer to [SIR Caution](#) in the Preface section.

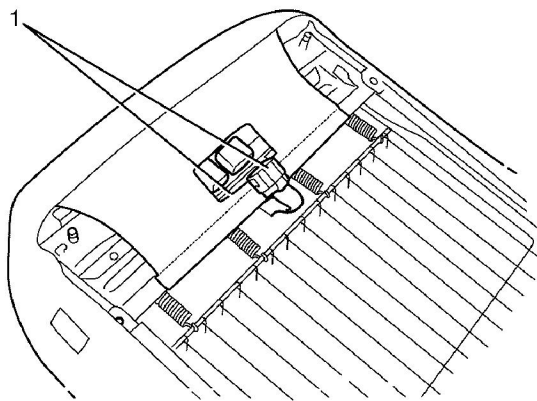

1. Disable the SIR system. Refer to [SIR Disabling and Enabling](#).
2. Remove the front seat. Refer to [Front Seat Replacement - Bucket](#).
3. Remove the front seat heater module. Refer to [Front Seat Heater Control Module Replacement](#).
4. Remove the front seat back adjuster. Refer to [Front Seat Recliner Knob Replacement](#).
5. Remove the front seat belt tensioner. Refer to [Driver and Passenger Seat Belt Tensioner Replacement](#).
6. Remove the seat outer trim cover. Refer to [Seat Cushion Outer Trim Panel Replacement](#).
7. Remove seat back assembly. Refer to [Front Seat Back Replacement](#).
8. Remove the seat adjuster. Refer to [Front Seat Adjuster Replacement](#).
9. Remove the seat cushion cover. Refer to [Front Seat Cushion Cover and Pad Replacement](#).
10. Disconnect the passenger presence electrical connector (1).

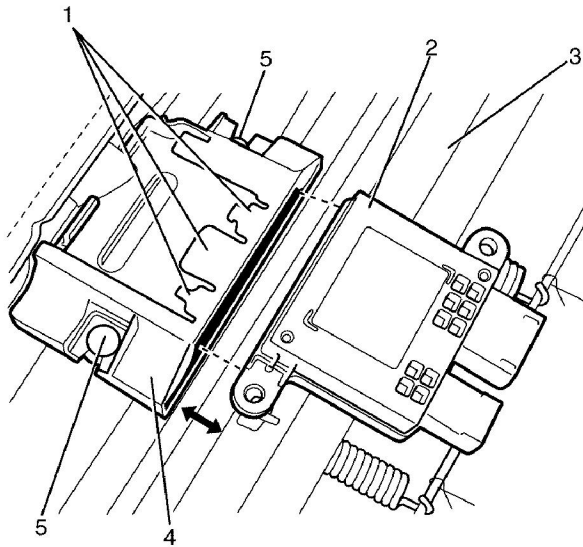

**Important:** The seat frame bracket retainers (5) are once-only items and must be discarded after removal.

11. Slightly lifting the retention tabs (1), move the passenger presence control module (2) outwards from the seat frame bracket (3).
12. Using suitable force, remove the seat frame bracket (3) from the seat frame (4) discarding the seat frame bracket retainers (5).

## Installation Procedure

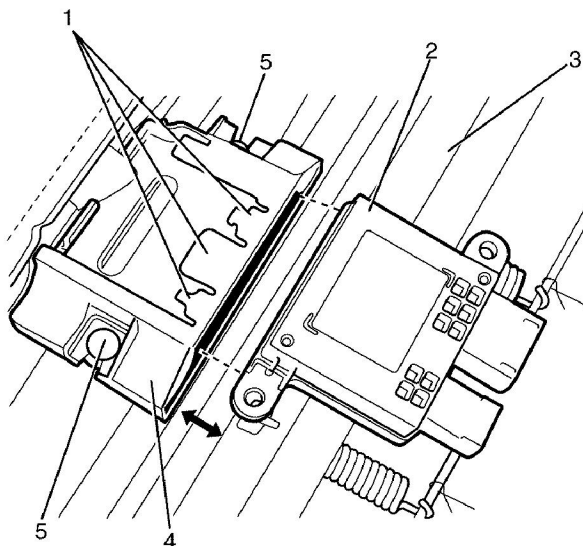

**Important:** The seat frame bracket retainers (5) are single use items and must be discarded after removal.

**Important:** The retention tabs (1) must audibly engage to provide secure location of the passenger presence control module (2) into the seat frame bracket (3).

1. Install the seat frame bracket (3) onto the seat frame (4) using NEW seat frame bracket retainers (5).
2. Install the passenger presence control module (2) into the seat frame bracket (3), engaging the retention tabs (1).

**Caution:** Refer to [SIR Caution](#) in the Preface section.

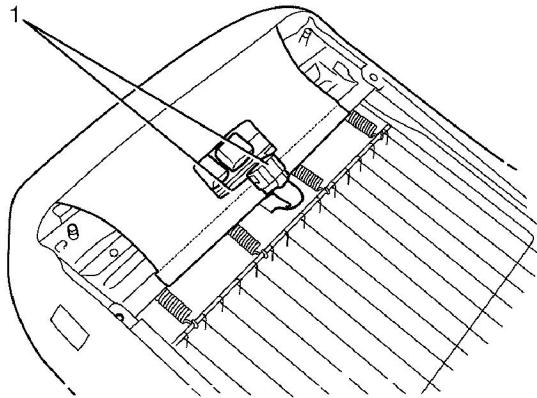

3. Connect the passenger presence electrical connector (1).
4. Install the seat cushion cover. Refer to [Front Seat Cushion Cover and Pad Replacement](#).
5. Install the seat adjuster. Refer to [Front Seat Adjuster Replacement](#).
6. Install seat back assembly. Refer to [Front Seat Back Replacement](#).
7. Install the seat outer trim cover. Refer to [Seat Cushion Outer Trim Panel Replacement](#).
8. Install the front seat belt tensioner. Refer to [Driver and Passenger Seat Belt Tensioner Replacement](#).
9. Install the front seat back adjuster. Refer to [Front Seat Recliner Knob Replacement](#).
10. Install the front seat heater module. Refer to [Front Seat Heater Control Module Replacement](#).
11. Install the front seat. Refer to [Front Seat Replacement - Bucket](#).
12. Enable the SIR system. Refer to [SIR Disabling and Enabling](#).
13. Re-zero the inflatable restraint passenger presence system whenever the seat cushion or any component of the passenger presence system is removed. Refer to [Passenger Presence System Programming and Setup](#).