

Manual Shift Shaft and Seal Replacement

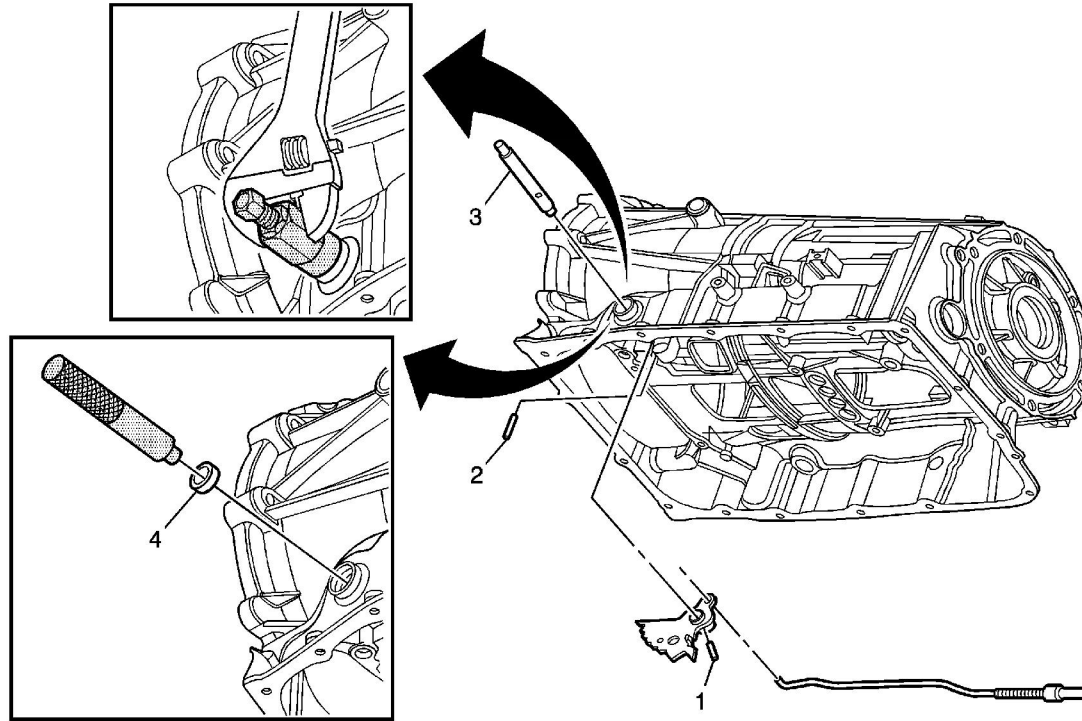

Callout	Component Name
<p>Preliminary Procedures</p> <ol style="list-style-type: none"> 1. Raise and support the vehicle. Refer to Lifting and Jacking the Vehicle. 2. Remove the transmission fluid pan. Refer to Automatic Transmission Fluid, Fluid Pan and/or Filter Replacement. 3. Remove the manual shaft detent assembly roller. Refer to Control Valve Lower Body and Upper Body Replacement. 	
1	<p>Manual Shaft Detent Lever Hub Pin</p> <p>Procedure</p> <ol style="list-style-type: none"> 1. Discard the pin. Replace with a NEW pin. 2. "Walk" the pin out using side cutters.
2	<p>Manual Shift Shaft Pin</p> <p>Procedure</p> <ol style="list-style-type: none"> 1. Discard the pin. Replace with a NEW pin. 2. "Walk" the pin out using side cutters.

3	Manual Shift Shaft
4	<p data-bbox="302 201 618 233">Manual Shift Shaft Seal</p> <p data-bbox="302 275 488 306">Procedure</p> <ol data-bbox="334 348 1308 443" style="list-style-type: none"><li data-bbox="334 348 1308 380">1. The manual shaft must be removed to replace the manual shaft seal.<li data-bbox="334 380 1308 411">2. Use the J 45201 to remove the seal from the transmission case.<li data-bbox="334 411 1308 443">3. Use the DT 47770 to install the seal into the transmission case. <p data-bbox="302 485 537 516">Special Tools</p> <ul data-bbox="350 558 837 642" style="list-style-type: none"><li data-bbox="350 558 837 590">• DT 47770 Seal Installer<li data-bbox="350 600 837 642">• J 45201 Cooler Line Seal Remover