

Seal Locations

Seal Locations

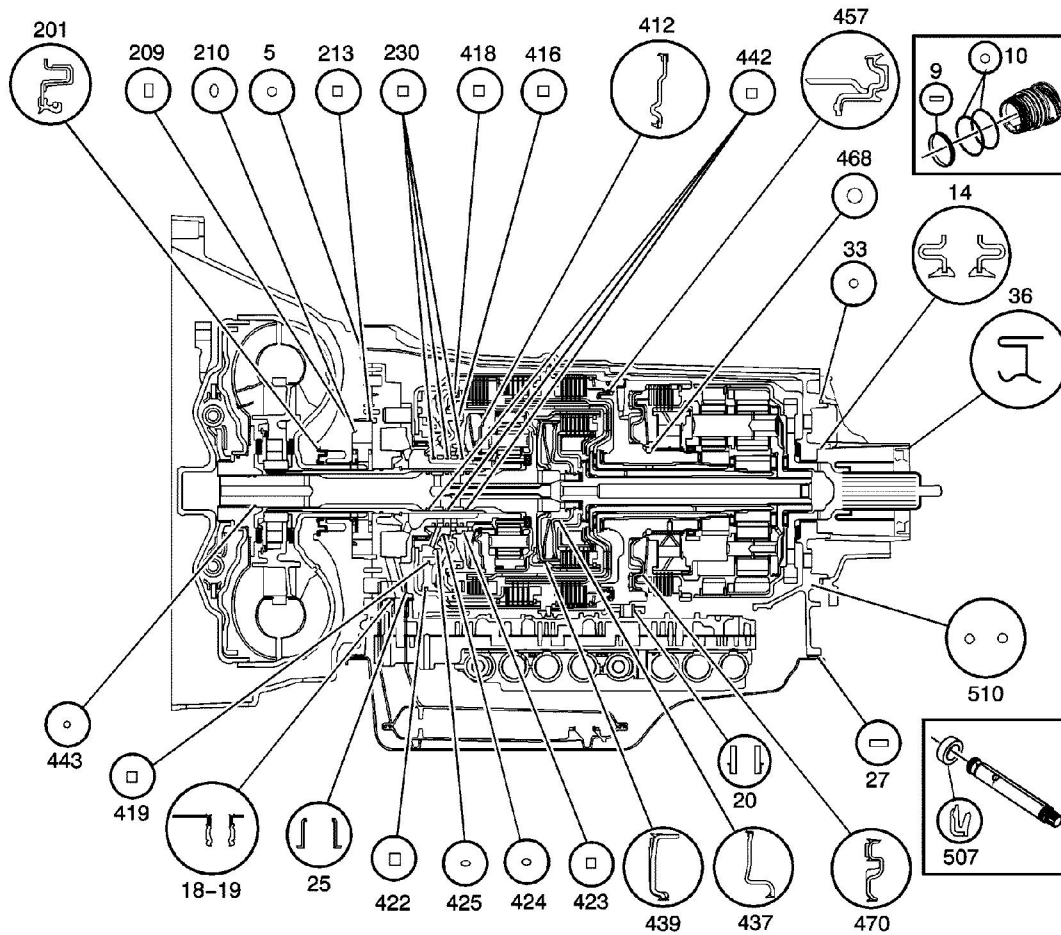

- (5) A/Trans Fluid Pump Seal
- (9) A/Trans Connector Seal
- (10) A/Trans Connector (O-ring) Seal
- (14) Output Shaft Seal Assembly
- (18) A/Trans Fluid Pump Seal Assembly
- (19) A/Trans Fluid Pump Seal Assembly
- (20) Centre Support Fluid Passage Seal Assembly
- (25) A/Trans Fluid Filter Seal Assembly
- (27) A/Trans Fluid Pan Gasket
- (201) Torque Converter Fluid Seal Assembly

© 2013 General Motors Corporation. All rights reserved.

- (209) A/Trans Fluid Pump Slide Fluid Seal Ring
- (210) A/Trans Fluid Pump Slide (O-ring) Seal
- (213) A/Trans Fluid Pump Slide Seal
- (230) 1-2-3-4 and 3-5 Reverse Clutch Fluid Seal Ring
- (412) 1-2-3-4 Clutch Piston Dam Assembly
- (416) 1-2-3-4 Clutch Piston Seal
- (418) 3-5 Reverse Clutch Piston Dam (O-ring) Seal
- (419) 3-5 Reverse Clutch Piston Inner Seal
- (422) 3-5 Reverse Clutch Piston Outer Seal
- (423) 1-2-3-4 Clutch Piston Inner Seal
- (424) 1-2-3-4 Clutch Piston Housing Seal
- (425) 1-2-3-4 Clutch Piston Housing Seal
- (437) 4-5-6 Clutch Piston Dam Assembly
- (439) 4-5-6 Clutch Piston Assembly
- (442) Turbine Shaft Fluid Seal Ring
- (443) Turbine Shaft (O-ring) Seal
- (457) 2-6 Clutch Piston Assembly
- (468) Low Clutch Sprag Seal
- (470) Low and Reverse Clutch Piston Assembly
- (507) Manual Shift Shaft Seal
- (510) Park Pawl Actuator Guide (O-ring) Seal