

Clutch Assemblies and Associated Parts

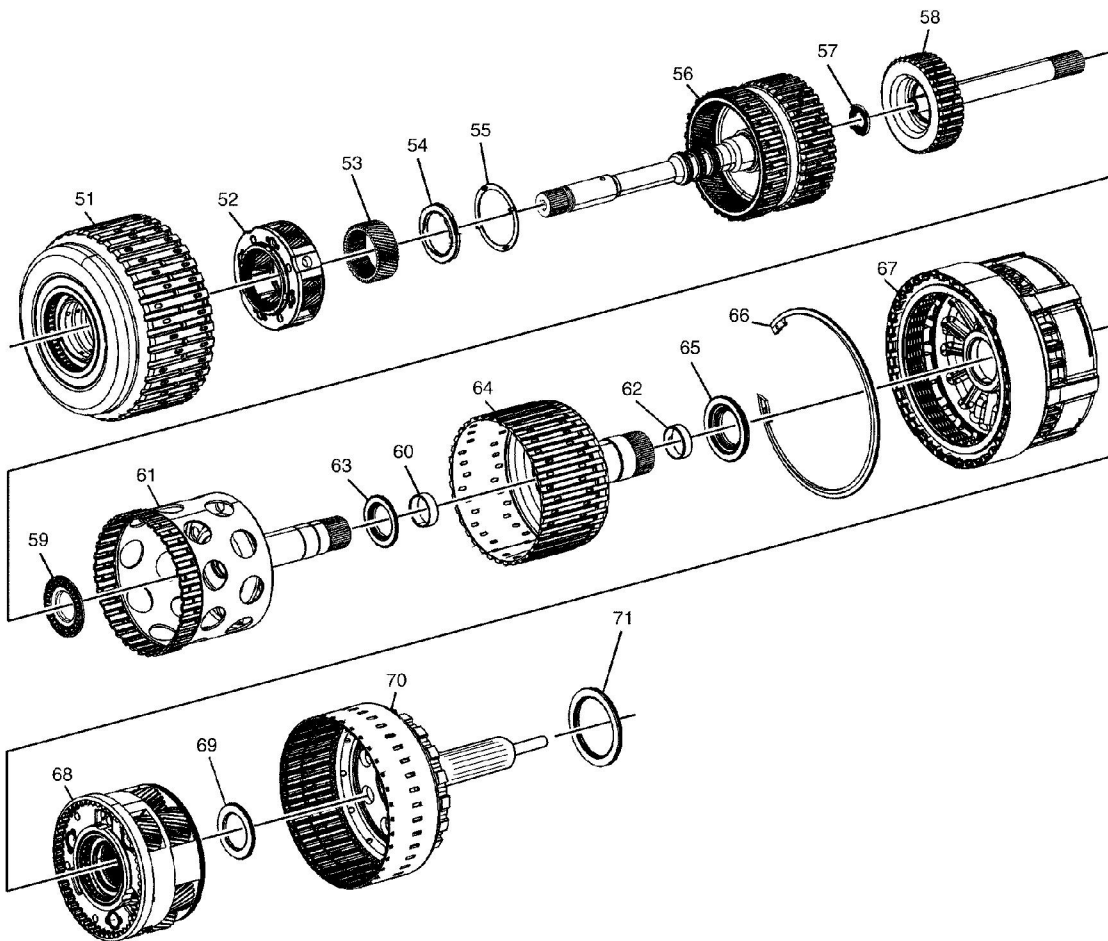

- (51) 1-2-3-4 and 3-5 Reverse Clutch Assembly
- (52) Input Carrier Assembly
- (53) Input Sun Gear
- (54) Input Sun Gear Thrust Bearing
- (55) Input Sun Gear Thrust Washer
- (56) 4-5-6 (w/ Turbine Shaft) Clutch Assembly
- (57) Turbine Shaft Thrust Bearing Assembly
- (58) 4-5-6 Clutch (w/ Output Carrier Shaft and Dampener) Hub Assembly
- (59) 4-5-6 Clutch Hub Thrust Bearing Assembly
- (60) Output Carrier Inner Sun Gear Shaft (Front) Bushing
- (61) 1-2-3-4 Clutch (w/ Output Carrier Inner Sun Gear Shaft) Hub Assembly
- (62) Output Carrier Inner Sun Gear Shaft (Front) Thrust Bearing
- (63) Output Carrier Inner Sun Gear Shaft (Front) Thrust Washer
- (64) Output Carrier Inner Sun Gear Shaft (Front) Thrust Washer
- (65) Output Carrier Inner Sun Gear Shaft (Front) Thrust Washer
- (66) Output Carrier Inner Sun Gear Shaft (Front) Thrust Washer
- (68) 4-5-6 Clutch Hub Thrust Bearing Assembly
- (69) Output Carrier Inner Sun Gear Shaft (Front) Thrust Bearing
- (70) Output Carrier Inner Sun Gear Shaft (Front) Thrust Washer
- (71) Output Carrier Inner Sun Gear Shaft (Front) Thrust Washer

© 2013 General Motors Corporation. All rights reserved.

- (62) Output Carrier Inner Sun Gear Shaft Bushing
- (63) 1-2-3-4 Clutch Hub Thrust Bearing Assembly
- (64) 2-6 and 3-5 Reverse Clutch (w/ Output Carrier Outer Sun Gear Shaft) Hub Assembly
- (65) 2-6 and 3-5 Reverse Clutch Hub Thrust Bearing Assembly
- (66) Centre Support Retaining Ring
- (67) Centre (w/ 2-6 Low and Reverse Clutch) Support Assembly
- (68) Output Carrier Assembly
- (69) Output Carrier Thrust Bearing Assembly
- (70) Output Shaft Assembly
- (71) Output Shaft Thrust Bearing Assembly