

1-2-3-4 and 3-5 Reverse Clutch Assembly

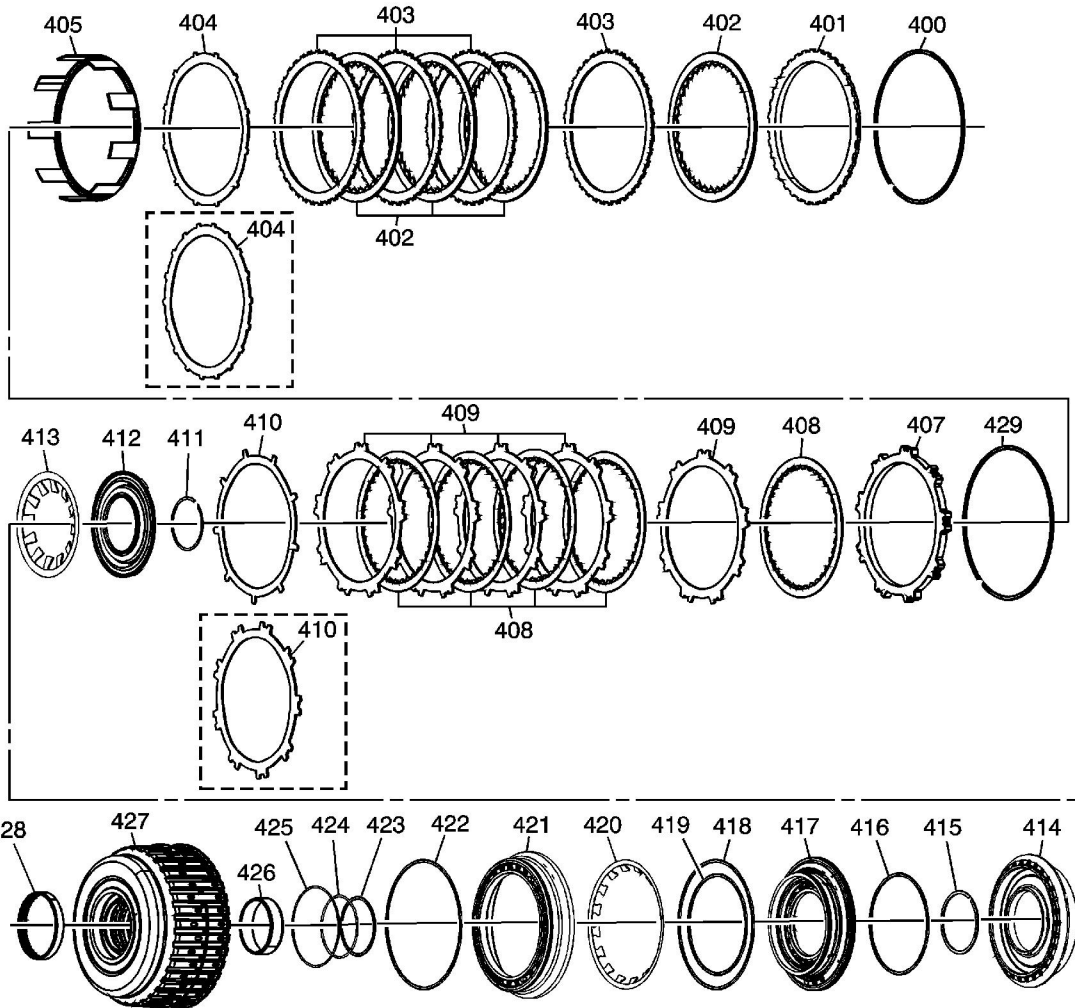

- (400) 3-5 Reverse Clutch Backing Plate Retaining Ring
- (401) 3-5 Reverse Clutch Backing Plate
- (402) 3-5 Reverse Clutch Plate Assembly
- (403) 3-5 Reverse Clutch Plate
- (404) 3-5 Reverse Clutch (Waved) Plate
- (405) 3-5 Reverse Clutch Apply Ring
- (407) 1-2-3-4 Clutch Backing Plate
- (408) 1-2-3-4 Clutch Plate Assembly
- (409) 1-2-3-4 Clutch Plate
- (410) 1-2-3-4 Clutch (Waved) Plate
- (411) 1-2-3-4 Clutch Piston Dam Retaining Ring

© 2013 General Motors Corporation. All rights reserved.

- (412) 1-2-3-4 Clutch Piston Dam Assembly
- (413) 1-2-3-4 Clutch Spring
- (414) 1-2-3-4 Clutch Piston
- (415) 1-2-3-4 Clutch Piston Housing Retaining Ring
- (416) 1-2-3-4 Clutch Piston Seal
- (417) 1-2-3-4 Clutch Piston Housing
- (418) 3-5 Reverse Clutch Piston Dam (O-ring) Seal
- (419) 3-5 Reverse Clutch Piston Inner Seal
- (420) 3-5 Reverse Clutch Spring
- (421) 3-5 Reverse Clutch Piston
- (422) 3-5 Reverse Clutch Piston Outer Seal
- (423) 1-2-3-4 Clutch Piston Inner Seal
- (424) 1-2-3-4 Clutch Piston Housing Seal
- (425) 1-2-3-4 Clutch Piston Housing Seal
- (426) 1-2-3-4 and 3-5 Reverse Clutch Housing Rear Bushing
- (427) 1-2-3-4 and 3-5 Reverse Clutch Housing Assembly
- (428) 1-2-3-4 and 3-5 Reverse Clutch Bearing Assembly
- (429) 1-2-3-4 Clutch Backing Plate Retaining Ring