

Control Valve Body Assembly Disassemble

Table 1: [Input and Output Speed Sensor Assembly Removal](#)

Table 2: [Manual Shaft Detent Assembly and Manual Shift Shaft Position Switch Removal](#)

Table 3: [Control Solenoid Valve Assembly Removal](#)

Table 4: [Upper and Lower Valve Bodies Disassemble](#)

Input and Output Speed Sensor Assembly Removal

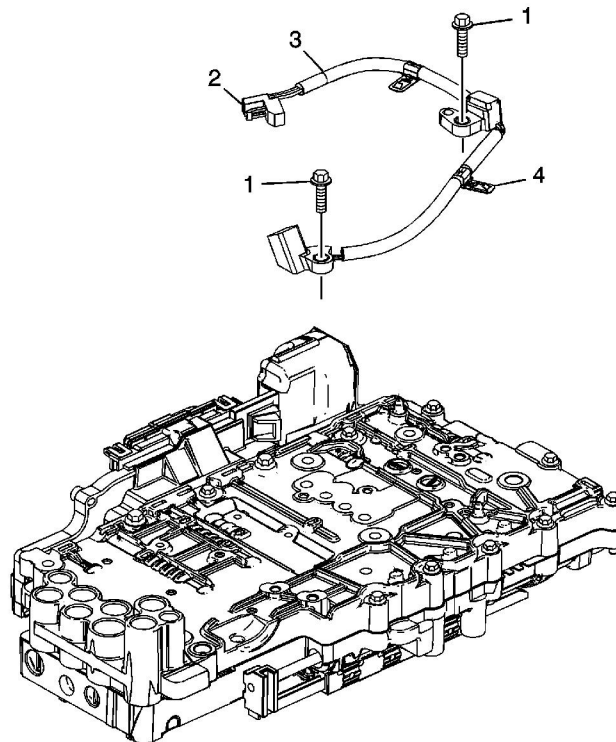

Input and Output Speed Sensor Assembly Removal

Callout	Component Name
1	Bolt M6 x 20 (Qty: 2)
2	Speed Sensor Electrical Connector Tip Release the connector lock before disconnecting.
3	A/Trans Input and Output Speed Sensor Assembly
4	A/Trans Input and Output Speed Sensor Wiring Harness Clip (Qty: 2) Tip Inspect the clips and replace if damaged.

© 2013 General Motors Corporation. All rights reserved.

Manual Shaft Detent Assembly and Manual Shift Shaft Position Switch Removal

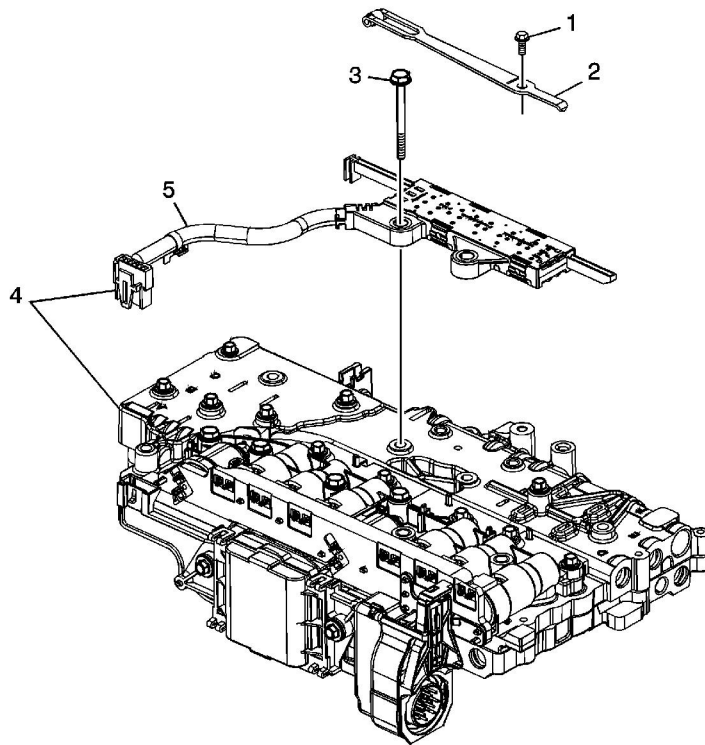

Manual Shaft Detent Assembly and Manual Shift Shaft Position Switch Removal

Callout	Component Name
1	Bolt M6 x 14.5
2	Manual Shaft Detent Assembly
3	Bolt M5 x 55
4	A/Trans Manual Shift Shaft Position Switch Assembly Electrical Connector Tip Release the connector lock before disconnecting.
5	A/Trans Manual Shift Shaft Position Switch Assembly

Control Solenoid Valve Assembly Removal

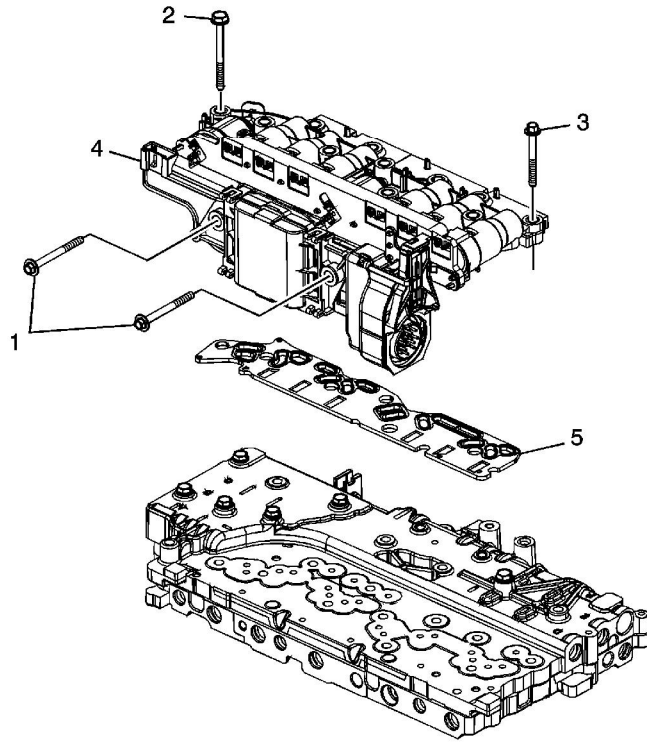

Control Solenoid Valve Assembly Removal

Callout	Component Name
1	Bolt M5 x 53 (Qty: 2)
2	Bolt M5 x 55 (Qty: 4)
3	Bolt M5 x 45 (Qty: 5)
4	Control Solenoid (w/Body and TCM) Valve Assembly Caution: Use care when handling the control valve body assembly. If dropped, damage to the control solenoid valve body assembly internal components, including the transmission control module (TCM), may result.
5	Filter Plate Assembly Caution: Use care when removing or installing the filter plate assembly. A broken or missing retaining tab may not adequately secure the filter plate to the control solenoid valve assembly, resulting in possible damage or contamination. Caution: Discard the filter plate. Replace with a NEW filter plate. Reusing an old filter plate may cause damage to the control solenoid valve assembly.

Upper and Lower Valve Bodies Disassemble

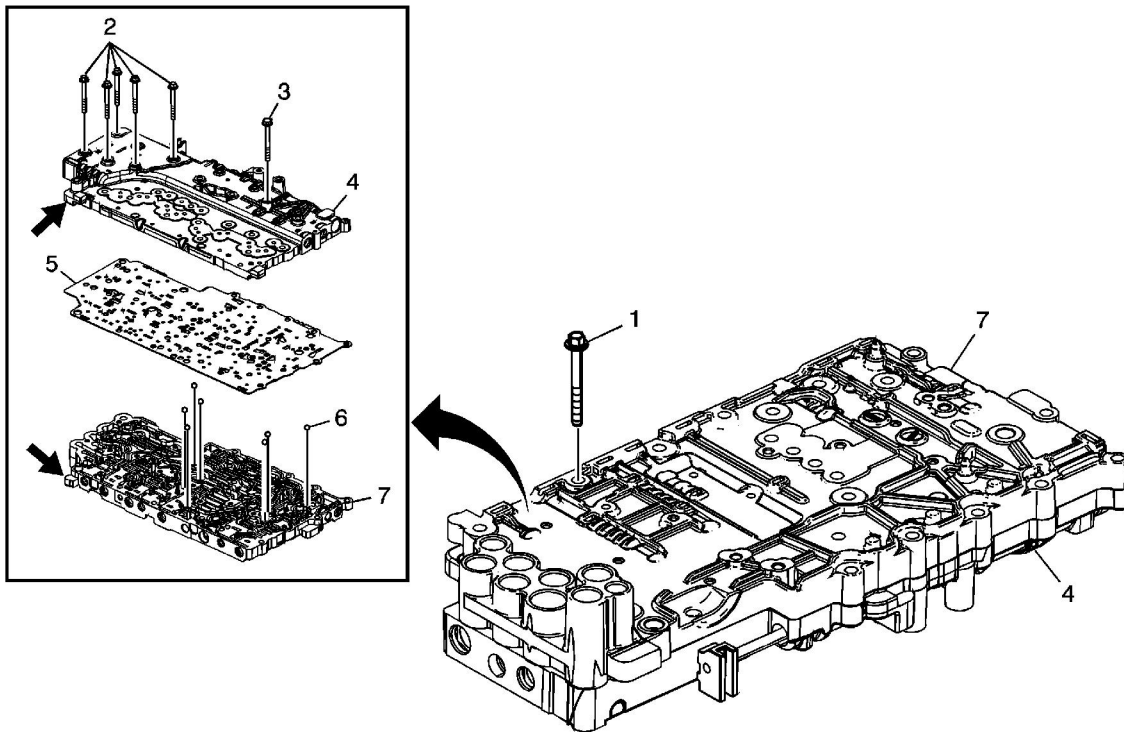

Upper and Lower Valve Bodies Disassemble

Callout	Component Name
1	Bolt M5 x 36 (Qty: 12)
2	Bolt M5 x 45 (Qty: 5)
3	Bolt M5 x 55
4	Control Valve Lower Body Assembly Tip <ul style="list-style-type: none"> Separate the upper and lower valve bodies by carefully prying at the point indicated. Refer to Control Valve Lower Body Assembly Cleaning and Inspection.
5	Control Valve Body Spacer (w/Gasket) Plate Assembly Caution: Do not use the old spacer plate. Install a NEW spacer plate. Reusing an old spacer plate may cause internal transmission leaks and transmission damage.
6	Control Valve Body Ball Check Valve (Qty: 7) Tip Note the position of the ball check valves.
7	Control Valve Upper Body Assembly Tip Refer to Control Valve Upper Body Assembly Cleaning and Inspection .