

1-2-3-4 and 3-5 Reverse Clutch Assembly and 4-5-6 Clutch Assembly Installation

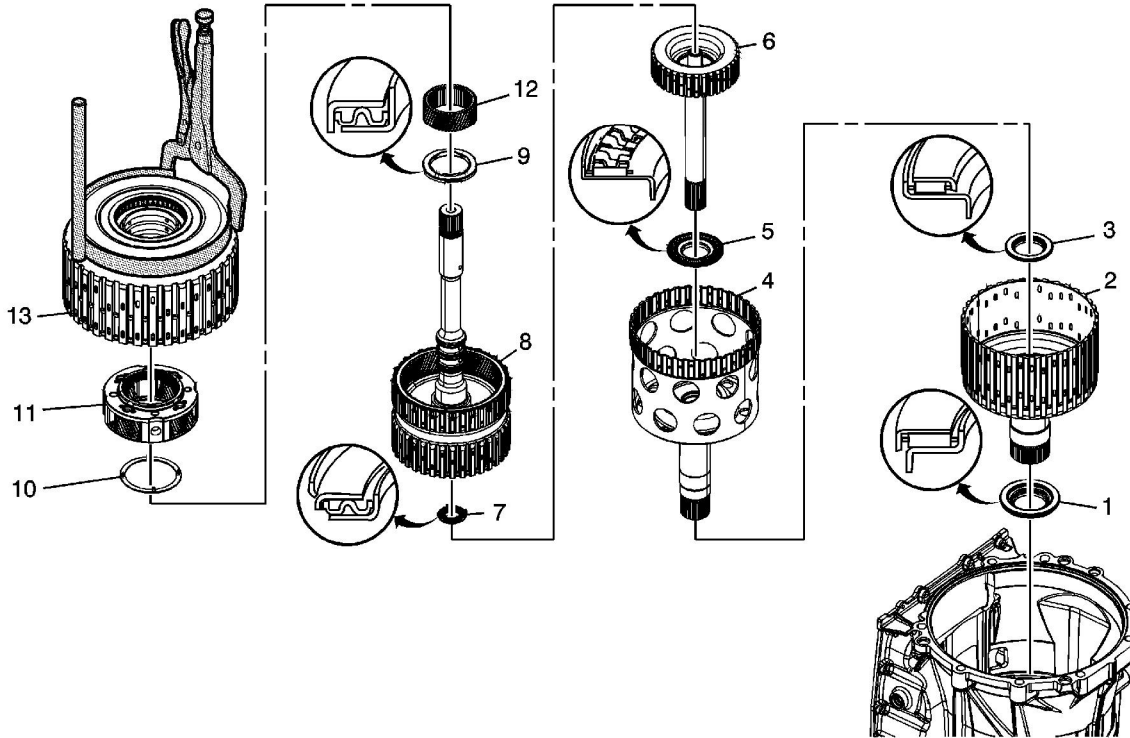

Callout	Component Name
1	2-6 and 3-5 Reverse Clutch Hub Thrust Bearing Assembly
2	2-6 and 3-5 Reverse Clutch (with Output Carrier Outer Sun Gear Shaft) Hub Assembly
3	1-2-3-4 Clutch Hub Thrust Bearing Assembly
4	1-2-3-4 Clutch (with Output Carrier Inner Sun Gear Shaft) Hub Assembly
5	4-5-6 Clutch Hub Thrust Bearing Assembly
6	4-5-6 Clutch (with Output Carrier Shaft and Dampener) Hub Assembly Tip Refer to 4-5-6 Clutch Dampener Overhaul .
7	Turbine Shaft Thrust Bearing Assembly
8	4-5-6 (with Turbine Shaft) Clutch Assembly
9	Input Sun Gear Thrust Bearing Tip Thrust bearing snaps onto input carrier assembly.

© 2013 General Motors Corporation. All rights reserved.

10	Input Sun Gear Thrust Washer
11	Input Carrier Assembly
12	Input Sun Gear
13	<p>1-2-3-4 and 3-5 Reverse Clutch Assembly</p> <p>Tip Wiggle the DT 47781 in order to align the 1-2-3-4 and 3-5 reverse clutch plates with the external splines of the 4-5-6 clutch assembly. To verify that the 1-2-3-4 and 3-5 reverse clutch assembly is fully installed, lift up on the turbine shaft. There should not be any noticeable slack.</p> <p>Special Tool</p> <p>DT 47781 C1234 35R Clutch Assembly Installer</p>