

## Torque Converter Housing with Fluid Pump Installation

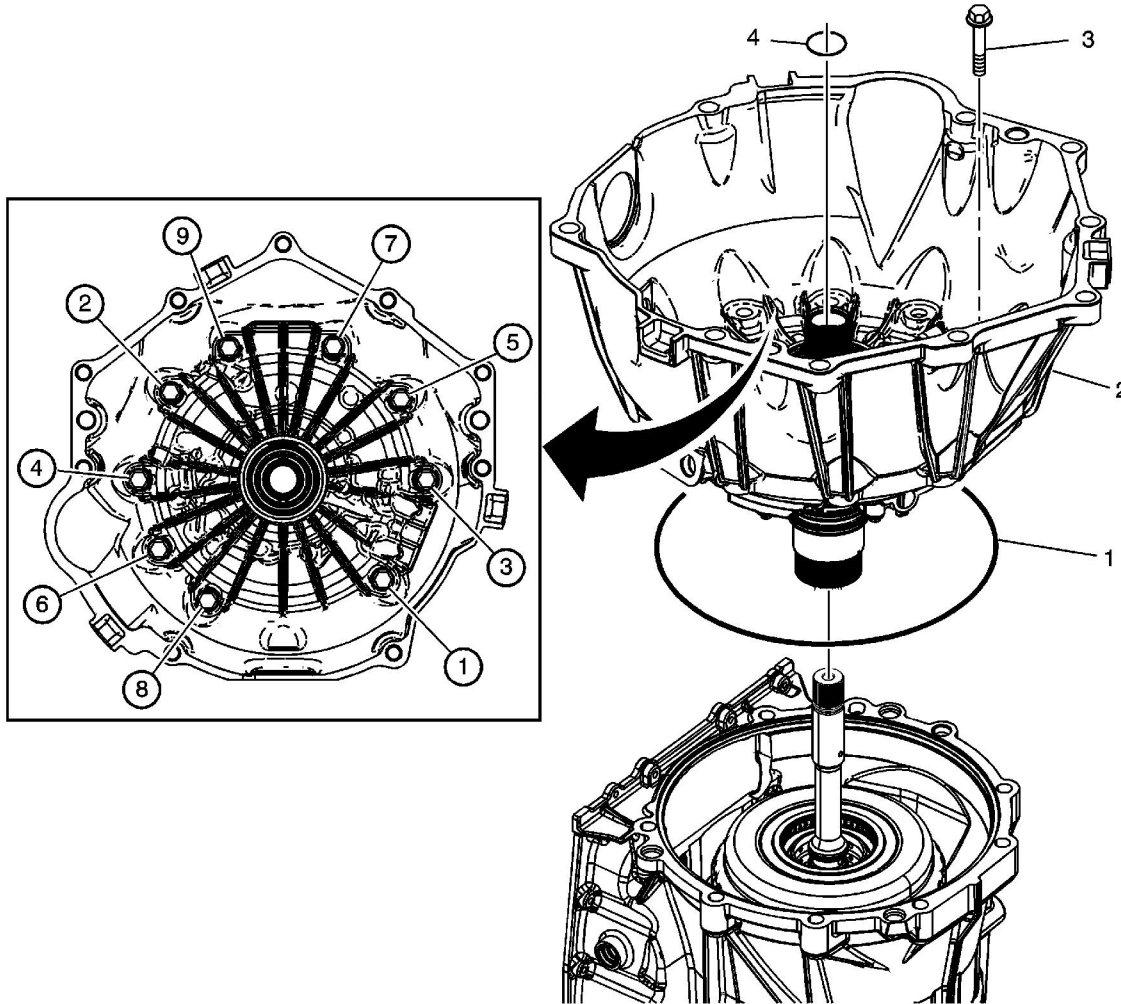

Callout	Component Name
1	NEW Fluid Pump Seal
2	Torque Converter (with Fluid Pump) Housing Assembly <b>Caution:</b> Ensure the turbine shaft (O-ring) seal is not installed prior to installing the torque converter housing assembly. The seal may become cut or damaged during installation of the torque converter housing assembly.
3	Bolts M10 x 50 (Qty: 9) <b>Caution:</b> Refer to <a href="#">Fastener Caution</a> in the Preface section.
<b>Procedure</b>	

© 2013 General Motors Corporation. All rights reserved.

	Tighten in the sequence shown.
	<b>Tighten</b> 72 N·m (53 lb ft)
4	NEW Turbine Shaft (O-Ring) Seal