

Automatic Transmission Shift Lock Control Actuator Replacement

Removal Procedure

1. Remove the floor shift control. Refer to [Transmission Control Lever Knob Replacement](#).
2. Using the manual override lever, shift the selector lever to the drive (D) position.

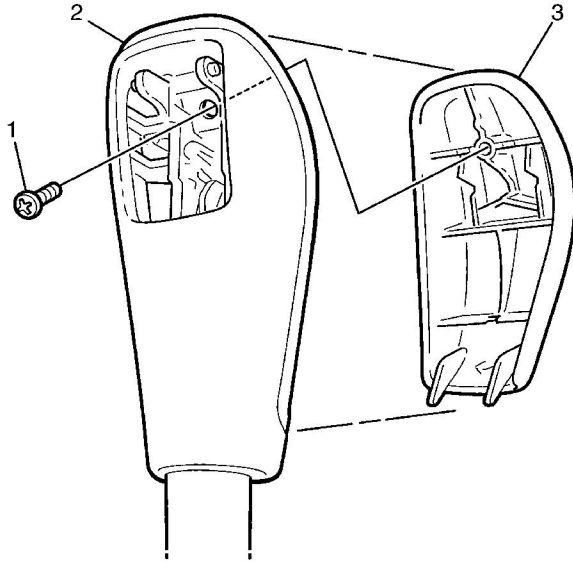

3. Remove the selector knob retaining screw (1), then remove the selector knob.

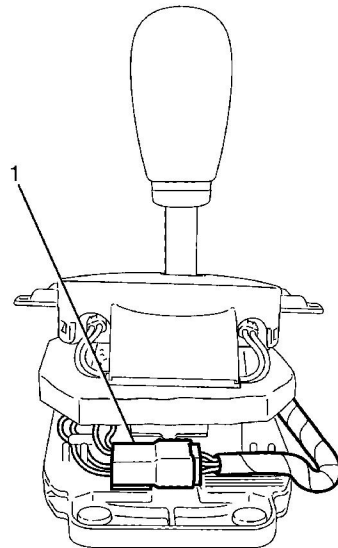

4. Disconnect the wiring harness connector (1) from the rear of the selector assembly.

© 2013 General Motors Corporation. All rights reserved.

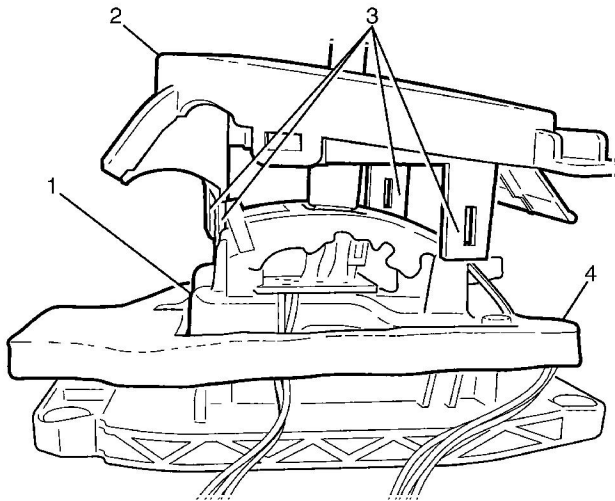

5. Disconnect the selector lever housing (2) from the base (1) by depressing the four retaining tabs (3).
6. Lift the shift lever housing assembly (2) from the base (1).
7. Remove the insulator (4) from the base (1).

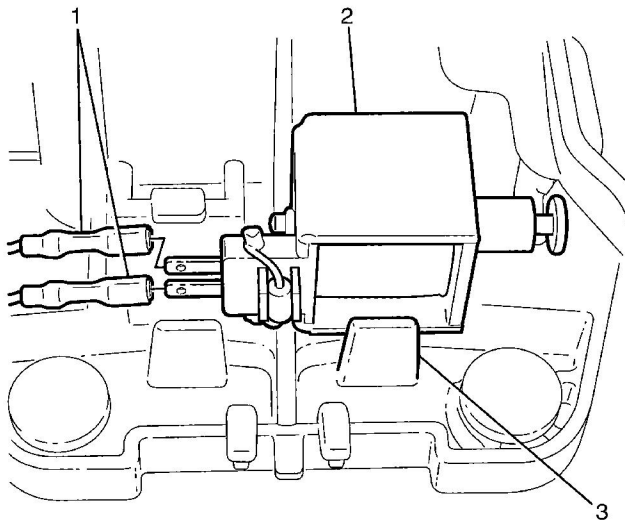

8. Disconnect the solenoid wiring harness connector (1) from the shift lock solenoid (2).
9. Disengage the solenoid retainer clip (3).
10. Remove the solenoid (2).

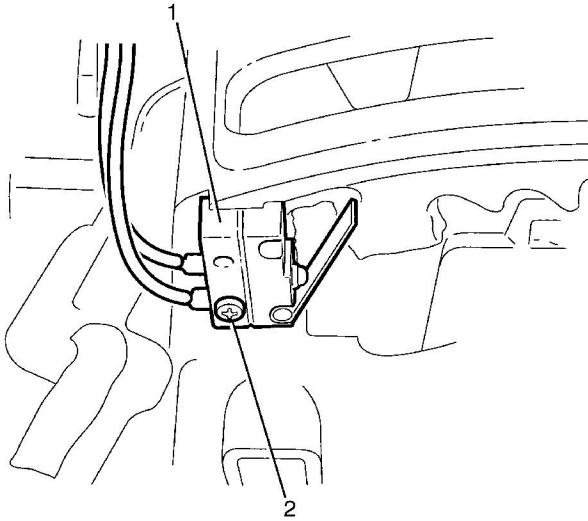

Note: After the solenoid is removed the lock tabs can be turned allowing access to micro switch screw.

11. If necessary, remove the park lock micro switch retaining screw (2).

Note: Note the position of the micro switch wiring harness routing for reassembly. The switches are incorporated into the wiring harness and cannot be serviced separately.

12. Remove the micro switch (1) and wiring harness from the floor shift control base plate.

Installation Procedure

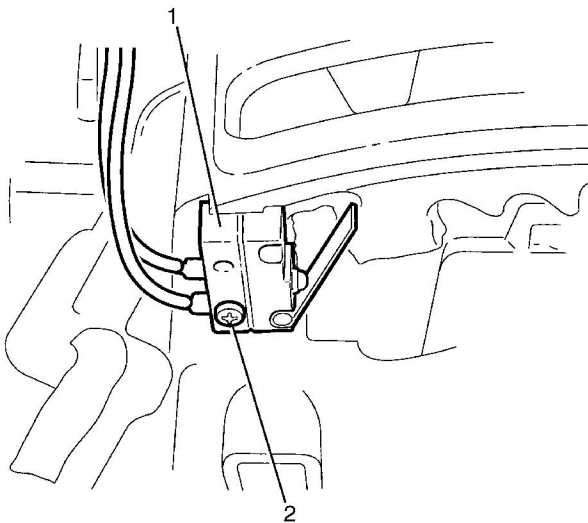



1. If removed, install the micro switch (1) and wiring harness to the floor shift control base plate.

Caution: Refer to [Fastener Caution](#) in the Preface section.

2. Install the park lock micro switch retaining screw (2) and tighten to **0.5 N·m (4 lb in)**.
3. Route the wiring harness insuring no contact with moving component and the wire is not stretched.

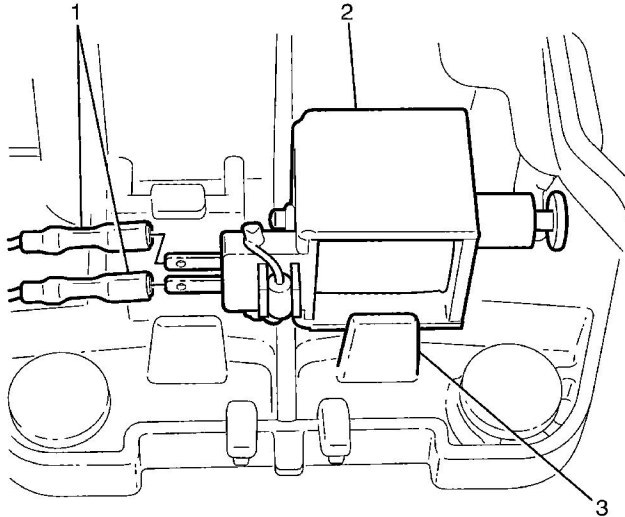

4. Install the solenoid into retaining clip (3).
5. Connect the solenoid wiring harness connector (1) to the shift lock solenoid (2).

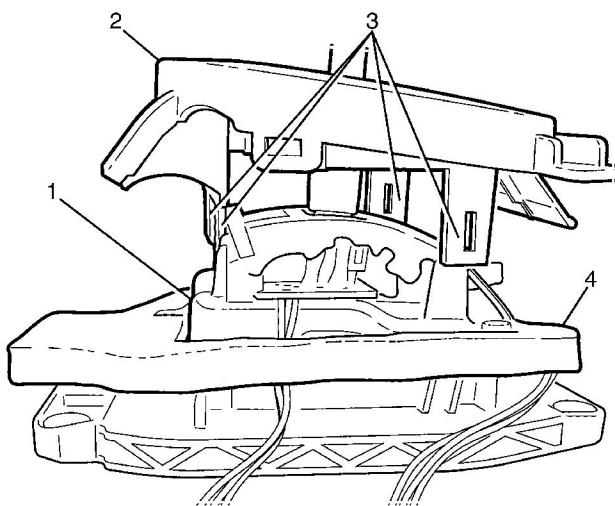

6. Install the insulator (4) to the base (1).

7. Connect the selector lever housing (1) to the base (2) by locking the 4 retaining tabs.

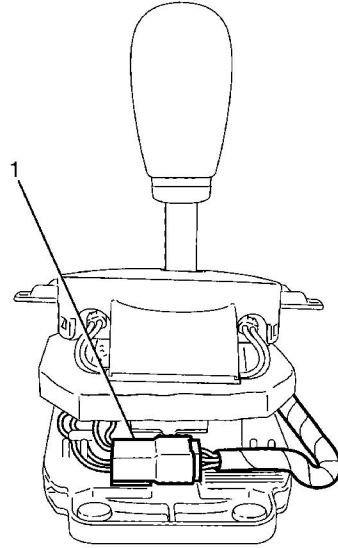

8. Connect the wiring harness connector (1) to the rear of the selector assembly.

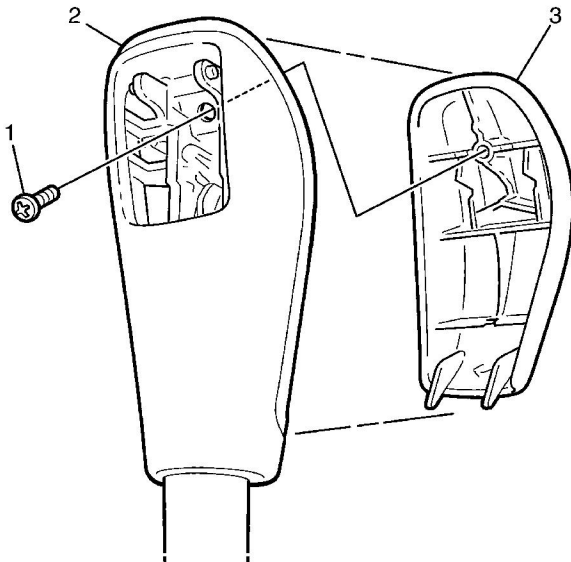

9. Install the selector knob, then install the selector knob retaining screw (1) and tighten to **2 N·m (18 lb in)**.
10. Install the floor shift control. Refer to [Transmission Control Lever Knob Replacement](#).