

# Manual Shift Shaft Seal Replacement

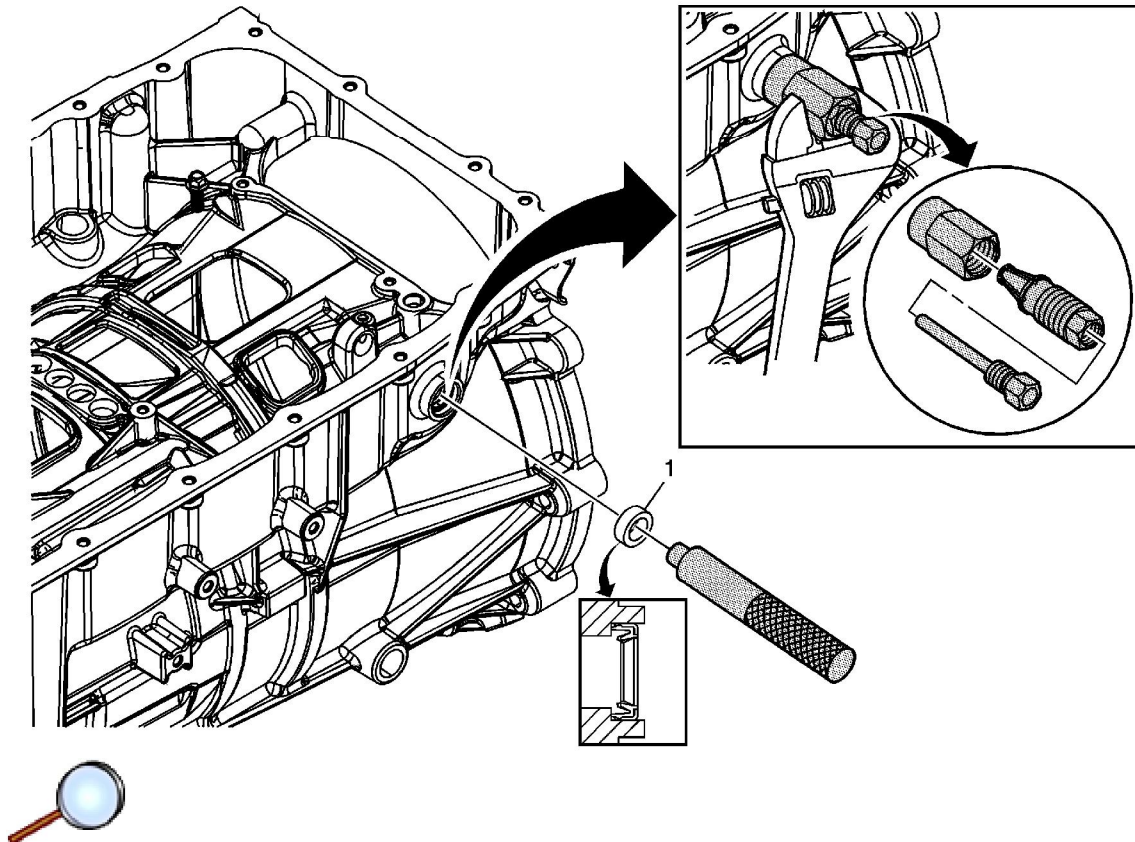

Callout	Component Procedure
<p>1</p>	<p>Manual Shift Shaft Seal</p> <p><b>Caution:</b> Do not damage the case bore during removal of the manual shift shaft seal.</p> <p><b>Caution:</b> When installing the seal, ensure the seal lip is firmly seated against the case bore surface. Do not allow the seal lip to be crushed, or a leak may result.</p> <p><b>Caution:</b> Refer to <a href="#">Seal Reuse Caution</a> in the Preface section.</p> <p><b>Special Tools</b></p> <ul style="list-style-type: none"> <li>• <i>DT 47770</i> Seal Installer</li> <li>• <i>J 45201</i> Cooler Line Seal Remover</li> </ul> <p>For equivalent regional tools, refer to <a href="#">Special Tools</a>.</p>